



## Take your receptions to new heights

### The most beautiful view of Paris

**All of Paris at your feet... What more outstanding setting could you imagine for all your receptions, parties and events? At over 200 metres, Espace 56 is the highest panoramic function room in Europe. Its refined, warm and contemporary decor, teak parquet flooring, filtered lighting, mirrors that reflect the Parisian lights, and large plate-glass windows make it both a grandiose and a sociable venue.**



### General features

- 56th floor of the Tour Montparnasse
- 196 metres above the Paris skyline
- Surface area: 350m<sup>2</sup>
- Capacity: up to 300 persons
- Design: fully convertible layout
- Room with spacious mezzanine floor with mirrored walls
- Panoramic view across Paris
- Excellent acoustic qualities for all types of musical events

### More reasons why your theme event and Espace 56 are a perfect match:

- The view: see further, the ideal location for your high ambitions...
- The height: use a record-setting room that rises to your occasion
- All of Paris in 360°: taking any event in the right direction...

### Types of services

- brand events and corporate events
- conventions, incentives, parties, TV and radio sets, media shows, official meetings, etc.
- private parties, gala evenings, society parties, etc.

## Customers who trusted us

- EUROSPOUR
- FRANCE TELEVISION
- BOUYGUES TELECOM
- LES NOUVEAUX CONSTRUCTEURS
- ACCOR
- LABORATOIRES KLORANE
- SOCIÉTÉ GÉNÉRALE
- CRÉDIT LYONNAIS
- SNCF
- RATP
- CAP GEMINI
- ADOBE
- VIVENDI UNIVERSAL
- KODAK
- TIMBERLAND

## HIGH STANDARDS WITHIN REACH

### Flexibility:

We have a range of formulas available to suit any budget: floor space hire, tailor-made formulas in association with our partners (seminar days including lunch at the gourmet restaurant on the 56th floor, cocktail parties, dance evenings, sit-down dinners, etc).

### Service:

We have our official caterer, Honoré James, at your service as well as a choice of five other listed caterers (Le Concurrent Gourmand, Fleur de Mets, Grand Chemin, Potel & Chabot, Riem Becker) and a number of service providers who can assist you with decoration, hosting, etc.

### Setting:

If your event takes place during the opening times of the panoramic visit of the 56th floor and the open-air roof terrace, your guests can enjoy the visit for free. There are also a number of interactive services with which visitors can gain a finer appreciation of the view and discover the capital.





## OUR EVENING FORMULAS: UNIQUE EVERY TIME...

In association  
with Honoré James caterer:

Our caterer of choice, Honoré James, is at your service to organise a unique event that will satisfy your high standards. We have worked with him to devise a range of formulas to suit your every need. Below are a few of the examples on offer:



**The 360° Cocktail from 114 €**

**A range of dinner\* formulas  
from 107 €**

**These prices are shown excluding VAT  
based on 100 guests,  
from 8.00 pm to midnight.**

- "Douceur d'un soir" dinner
- "Entre ciel et terre" dinner
- "Sous les étoiles" dinner

\*Details of these formulas are available on request.





## OUR CORPORATE FORMULAS: MEETING YOUR HIGH EXPECTATIONS, ALL DAY LONG

We have put together a complete formula with our gourmet restaurant "Le Ciel de Paris" for your all-day seminars, conferences or other events. Located on the same floor as Espace 56, this culinary temple creates magnificent treats for the eyes and the taste buds to the delight of your guests.



**Formula\* from 99 € excl. VAT  
based on 100 guests,  
from 9.00 am to 6.00 pm**



Programme:

- Reception (served at Espace 56): coffee, tea, croissants, brioches and pastries, orange juice
- Morning break (served at Espace 56): coffee, tea, biscuits, orange juice
- Lunch at the "Le Ciel de Paris" restaurant
- Refreshment break (served at Espace 56): coffee, tea, biscuits, orange juice

\* Details of this menu and the arrangements for the all-day formula available on request.

## PRICES FOR 2009

### Functions, cocktail parties, conferences, seminars, product presentations, etc.

	Excl. VAT	VAT	Incl. VAT
Half day, 4 hours	2 257.53 €	442.47 €	2 700.00 €
Full day from 9.00 am to 6.00 pm	3 185.62 €	624.38 €	3 810.00 €
Full day from 9.00 am to 8.00 pm	4 306.02 €	843.98 €	5 150.00 €
Per additional hour thereafter	392.98 €	77.02 €	470.00 €

### Evening meals and cocktail parties

From 7.00 pm to midnight	3 804.35 €	745.65 €	4 550.00 €
Per additional hour thereafter	392.98 €	77.02 €	470.00 €

### Functions from 10.00 pm to 5.00 am the following morning

Up to 300 people	3 913.04 €	766.96 €	4 680.00 €
------------------	------------	----------	------------

## Related services:

- Round table (150 cm diameter): 11 € excl. VAT
- Velvet-backed chair: 2 € excl. VAT



## Security personnel:

**230 € excl. VAT (per agent)**

**(Depending on the number of guests, 2 to 4 security agents will be assigned to oversee your event).**

# TECHNICAL INFORMATION



**Located on the 56th floor, Espace 56 is fully air conditioned.**

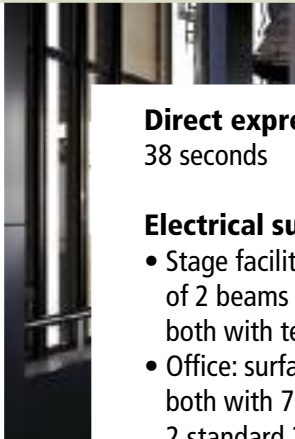

**Surface area:** 350 m<sup>2</sup>

**Direct express elevators:**  
38 seconds

### Electrical supply

- Stage facilities consisting of 2 beams with electrical power, both with ten 16A sockets.
- Office: surface area 12 m<sup>2</sup>, 2 boards both with 7 standard 16A sockets, 2 standard 20A sockets for plugging in appliances and heaters.

### Equipment room

20 m<sup>2</sup>, two 20A and four 16A sockets

### Signposts

On the ground floor and the 56th floor

### Floor to ceiling height

Mezzanine 2.85 m  
Perimeter 3.90 m

### Furniture available

- 60 folding chairs
- 10 tables (0.80 x 1.20 m)
- 10 pedestal tables (diameter 0.76 m)
- Cloakroom equipment

### Equipment for hire

- 150 velvet-backed chairs
- 15 Round Tables (150 cm diameter)

### Deliveries to ESPACE 56

**8.00 am to 12 noon and 2.00 pm to 6.00 pm Monday to Friday**  
Tel. 01 45 38 70 54 • Fax 01 45 38 69 96

### Access

Deliveries can be made by van or lorry. Maximum height 3.20 metres. Enter via 10 rue du Départ and down to 2nd lower ground floor of the public car park. There, turn left and follow sign to "Livraisons Tour".

### Goods elevator

From 2nd lower ground floor, rue du Départ.  
Capacity: 2 tonnes  
Dimensions:  
H 2.52 m - L 1.10 m - D 1.96 m  
Availability periods  
(please see terms of use).

### North goods elevator

Direct service to the 56th floor. Must only be used during the following periods and with prior approval:  
- Monday - Friday: 8.00 am – 12 noon and 2.00 pm – 6.00 pm  
- Saturday: 7.00 am – 12 noon

### South goods elevator

Take the north goods elevator to the 1st floor. Then take the south goods elevator directly to Espace 56.





# ESPACE 56

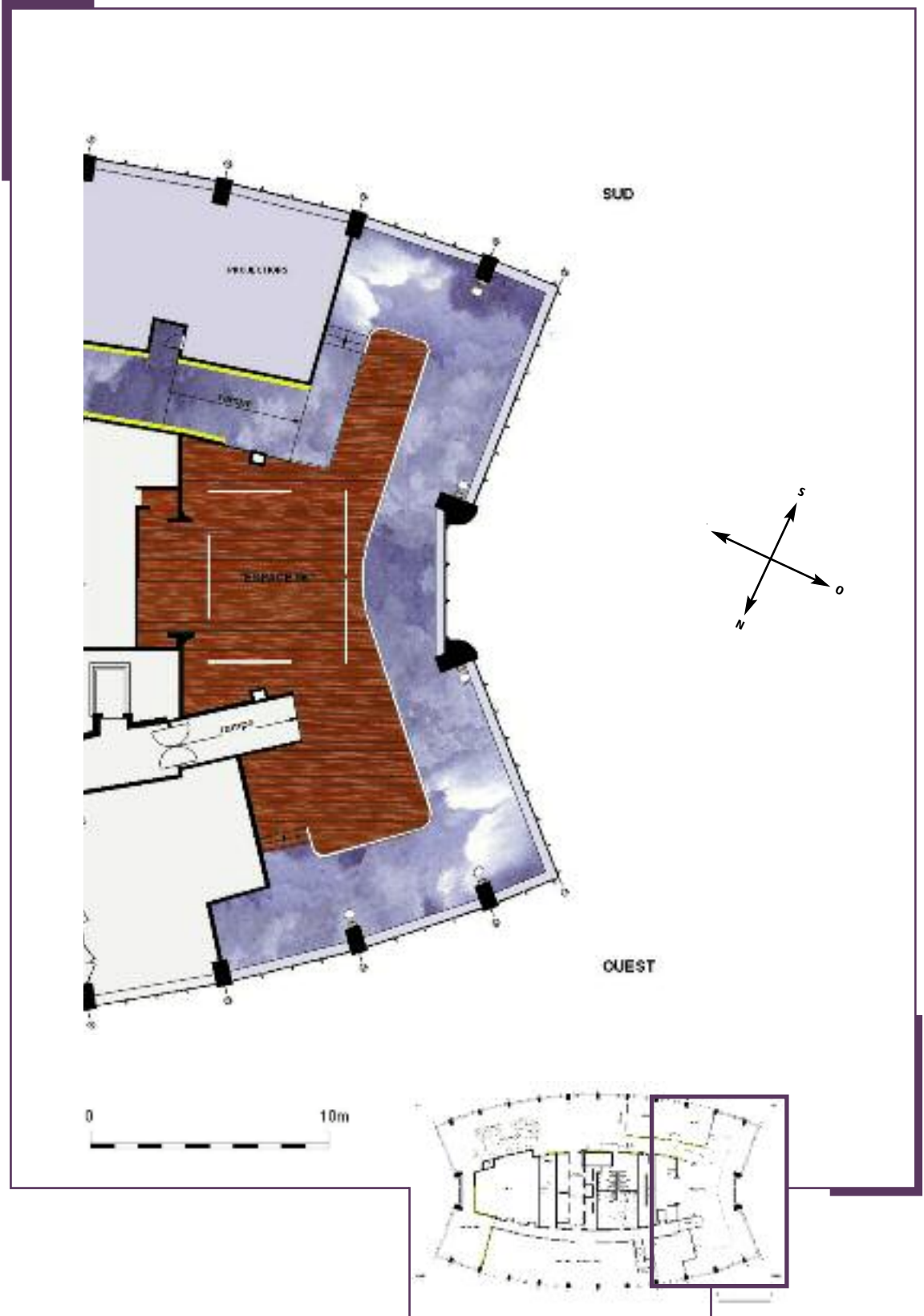

• 7